

5R65

JSY5R65DS1-A1903

SEIKO WATCH CORPORATION

Copyright©2019 by SEIKO WATCH CORPORATION

Printed in Japan

S-3

SEIKO

5R65

飽和潜水用防水ダイバーズウォッチ 取扱説明書
DIVER'S WATCH FOR SATURATION DIVING INSTRUCTIONS

日本語 **JA** 1

English **EN** 1

そのほかの言語の取扱説明書は、パソコンや
スマートフォンから当社ホームページ内の
「カスタマーサービス」>「取扱説明書ダウンロード」
にアクセスいただき、ご覧ください。

Please refer to the Instruction Manuals
of other languages by accessing
"Customer Service"→ "Instruction"
on our Website from PC or Smartphone.

Deutsch / Français / Italiano / Español /

Русский язык / العربية / Português /

简体中文 / 繁體中文 / 한국어 / ไทย



<https://www.seikowatches.com/>

**Thank you very much for choosing a SEIKO watch.
For proper and safe use of your SEIKO watch,
please read carefully the instructions in this
booklet before using it.**

Keep this manual handy for easy reference.

- * Length adjustment service for metallic bands is available at the retailer from whom the watch was purchased. If you cannot have your watch repaired by the retailer from whom the watch was purchased because you received the watch as a gift, or you moved to a distant place, please contact SEIKO CUSTOMER SERVICE CENTER. The service may also be available on a chargeable basis at other retailers, however, some retailers may not undertake the service.
- * If your watch has a protective film for preventing scratches, make sure to peel it off before using the watch. If the watch is used with the film on it, dirt, sweat, dust, or moisture may be attached to the film and may cause rust.

⚠ CAUTION

Make sure to read the following instructions before use and strictly observe them.

⚠ CAUTION

Inspect the following items before diving:

- The watch is normally operating.
- The remaining battery level is sufficient and the mainspring is sufficiently wound.
- The rotating bezel turns smoothly. (The bezel rotation must not be too loose or too tight.)
- Screws of the crown and other parts are reliably tightened.
- No abnormalities such as flaws or cracks exist on the band or glass.
- The band is reliably fixed (with spring bar, buckle or other parts.)

* If any abnormality is observed in the above items, do not use this watch for diving.

⚠ CAUTION

Do not operate the crown or buttons underwater.

⚠ CAUTION

As the use environment of the diver's watch may affect not only the case or band but also the internal mechanism of the watch, we recommend that you periodically request an overhaul for inspection and adjustment approximately once every three to four years.

⚠ WARNING

Make sure to read the following instructions before use and strictly observe them.

⚠ WARNING

When diving, never carry out operations other than those specified in this instruction manual. Mishandling of the product and misunderstanding of the displayed content may lead to a fatal or serious accident.

⚠ WARNING

The diver's watch is an auxiliary instrument which mainly displays the passage of time and does not ensure the safety of a user. Use this watch while using the equipment (residual pressure gauge, water depth meter, etc.) required for safe diving.

⚠ WARNING

This watch supports usage in saturation diving. Ensure you have the skills and experience necessary for saturation diving; that you have fully familiarized yourself with watch operation and handling; and that you check the watch each time before diving. If these items have not been confirmed, then do not carry out saturation diving using this watch.

CONTENTS

1 HOW TO USE

Handling cautions	5
Precautions for diving (Please make sure to observe the following.)	9
Before diving	9
While diving	11
After diving	12
Structure of the case	13
Water resistant performance	14
Characteristics	15
Names of the parts and their functions	16
Screw down crown	17
How to use (how to wind the mainspring)	18
How to set the time and date	21
Date adjustment at the end of the month ...	25
How to read the power reserve indicator	26
How to use the rotating bezel	28

2 TO PRESERVE THE QUALITY OF YOUR WATCH

Daily care	30
Performance and type	31
Lumibrite	32
Magnetic resistant performance	33
Band	35
How to use the diver adjuster	37
How to use the diver extender	39
After sales service	41
Troubleshooting	43
Specifications	45

Handling cautions

⚠ WARNING

Please note that there is a risk of serious consequences such as severe injury if the following safety regulations are not strictly observed.

Immediately stop wearing the watch in following cases:

- If the watch body or band becomes edged by corrosion etc.
- If the pins protrude from the band.
- * Immediately consult the retailer from whom the watch was purchased or SEIKO CUSTOMER SERVICE CENTER.

Keep the watch and accessories out of the reach of babies and children.

Care should be taken to prevent a baby or a child accidentally swallowing the accessories. If a baby or child swallows the battery or accessories, immediately consult a doctor, as it will be harmful to the health of the baby or child.

EN 5

⚠ WARNING

Make sure you carefully check the depth rating indicated on the watch dial or on the case back, and never use the watch underwater deeper than the specified depth.

⚠ WARNING

While diving, never operate the watch in any other manner than set forth in the instruction manual.

⚠ WARNING

Before using the diver's watch, you have to be properly trained in various types of diving and possess the requisite experience and skill to dive safely. When diving, strictly abide by the rules of diving.

EN 7

⚠ CAUTION

Please note that there is a risk of minor injury or material damage if the following safety regulations are not strictly observed.

Avoid the following places for wearing or keeping the watch:

- Places where volatile agents (cosmetics such as polish remover, bug repellent, thinners etc.) are vaporizing
- Places where the temperature drops below 5°C or rises above 35°C for a long time
- Places affected by strong magnetism or static electricity
- Places affected by strong vibrations
- Places of high humidity
- Dusty places

If you observe any allergic symptoms or skin irritation

Stop wearing the watch immediately and consult a specialist such as a dermatologist or an allergist.

Other cautions

- For adjusting the length of the metallic band, specialized knowledge and expertise are necessary. Therefore, in such a case, contact the retailer from whom the watch was purchased. If you attempt to adjust the metallic band, injury may occur to your hand or fingers, or parts of the band may be lost.
- Do not disassemble or tamper with the watch.
- Keep the watch out of the reach of babies and children. Extra care should be taken to avoid risks of any injury or allergic rash or itching that may be caused when they touch the watch.
- If your watch is of the fob or pendant type, the strap or chain attached to the watch may damage your clothes, or injure the hand, neck, or other parts of your body.

EN 6

⚠ CAUTION

Please note that there is a risk of minor injury or material damage if the following safety regulations are not strictly observed.



Do not turn or pull out the crown when the watch is wet.

Water may get inside of the watch.

* If the inner surface of the glass is clouded with condensation or water droplets appear inside of the watch for a long time, the water resistant performance of the watch is deteriorated. Immediately consult the retailer from whom the watch was purchased or SEIKO CUSTOMER SERVICE CENTER.



Do not leave moisture, sweat and dirt on the watch for a long time.

Be aware of a risk that a water resistant watch may lessen its water resistant performance because of deterioration of the adhesive on the glass or gasket.



Do not wear the watch while taking a bath or a sauna.

Steam, soap or some components of a hot spring may accelerate the deterioration of water resistant performance of the watch.

EN 8

1 Precautions for diving (Please make sure to observe the following.)

HOW TO USE

■ Before diving

Before diving, check the following:

* "Names of the parts and their functions" → P. 16

1 The time is correctly set.

2 The power reserve indicator shows the level of remaining power not less than one-half.

If the remaining power shows less than one-half, manually wind the mainspring. Refer to "How to manually wind the mainspring by turning the crown" → P. 18

3 The rotating bezel turns smoothly. (The bezel rotation must not be too loose or too tight.)

* "How to use the rotating bezel" → P. 28

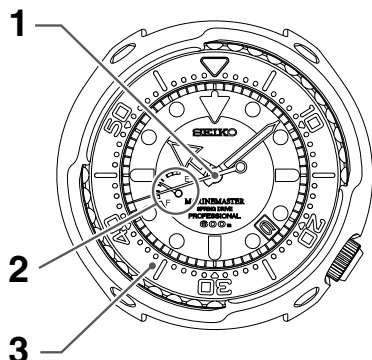

4 The crown is completely screwed in.

* "Screw down crown" → P. 17

5 There are no visible cracks or scratches on the crystal or watch band.

6 The band is firmly attached to the watch (with spring bars, clamp or other parts.)

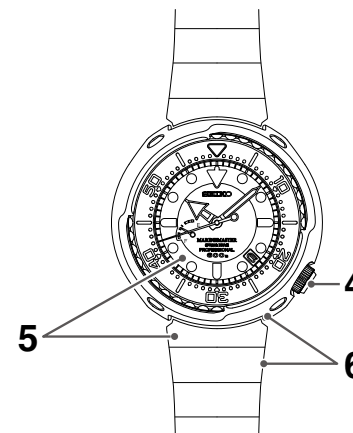

⚠ CAUTION

If there are any malfunctions, contact the retailer from whom the watch was purchased or SEIKO CUSTOMER SERVICE CENTER.

EN 9

EN 10

1 While diving

Please observe the following cautions for use.

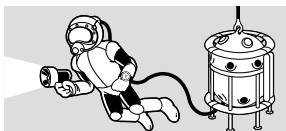

The watch can be used for air diving or saturation diving within the water resistant range displayed on the dial.

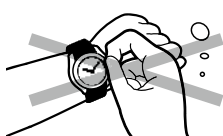

Do not operate the crown or buttons underwater.



Take care not to bump the watch against hard objects such as rocks.



Bezel rotation may become slightly harder in the water but this is not a malfunction.

■ After diving

Please follow the care instructions below after diving.

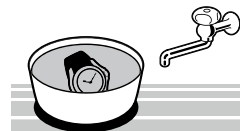

Rinse the watch in fresh water to wash out all seawater and wipe it thoroughly dry to prevent rust. Avoid pouring running water onto the watch directly from a faucet. Put some water into a bowl first, and then soak the watch in the water to wash it.



⚠ CAUTION

Depending on the environment where a diver's watch is used, its inner parts or movement as well as its case or band may be affected. We recommend that you have your watch overhauled regularly once every 3 or 4 years.

EN 11

EN 12

HOW TO USE

HOW TO USE

HOW TO USE

■ Structure of the case

In the following types of models, take care of the following issues in usage.

The bezel or protective outer case is securely fastened to the watch with setscrews.
Never loosen the setscrews.



* The above illustration is provided as an example, therefore it may not be exactly the same as your watch.

⚠ CAUTION

Never loosen the setscrews used to fix the bezel or protective outer case.
Doing so may cause damage or result in further loosening.

* If you find that the setscrews have become loose or are functioning abnormally, consult the retailer from whom the watch was purchased or SEIKO CUSTOMER SERVICE CENTER.

Characteristics

● Spring Drive

Spring Drive, the unique mechanism made available only by SEIKO technology, ensures quartz accuracy while using the mainspring as its sole power source.

The watch will work continuously for approximately 72 hours (three days) when the mainspring is fully wound. The watch features a power reserve indicator to show the winding state of the mainspring. The sweep seconds hand works in a perfectly smooth movement. This is a self-winding watch equipped with a manual winding mechanism.

When first using the watch, manual winding is more convenient.

⚠ CAUTION

This watch is powered by the mainspring. To ensure constant operation of the watch, be sure to wind up the mainspring sufficiently before the power reserve indicator points to "0."

The watch may stop if the power reserve indicator is showing less than one-sixth, especially it is left under a temperature below 0 °C.

Water resistant performance

● Water resistance for saturation diving

This watch is specially designed for use in saturation diving, which requires helium gas.

Make sure you carefully check the depth rating of your watch, which is indicated either on the watch dial or on the case back. Never use the watch underwater deeper than the specified depth.

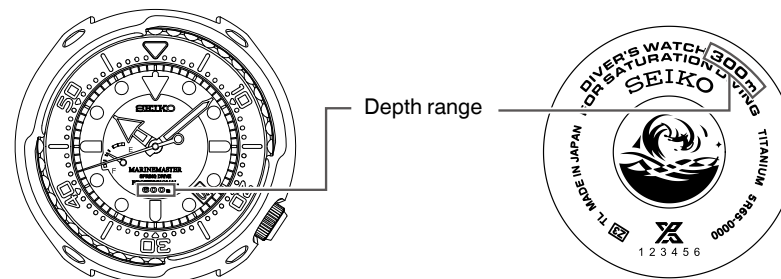

* The above illustration is provided as an example, therefore it may not be exactly the same as your watch.

Names of the parts and their functions

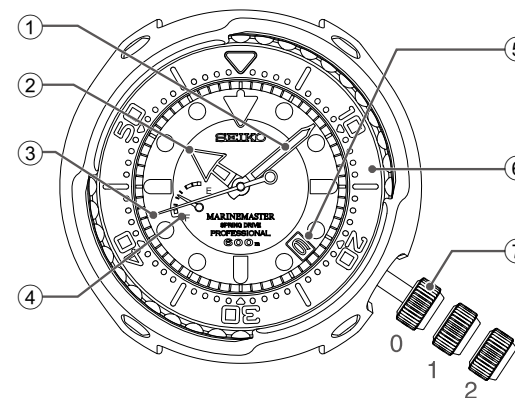

- ① Minute hand
- ② Hour hand
- ③ Seconds hand
- ④ Power reserve indicator
- ⑤ Date
- ⑥ Rotating bezel
- ⑦ Crown
 - Normal position (not locked): Wind up the watch (hand-wound)
 - First click position: Time difference adjustment/ Date setting
 - Second click position: Time setting

Screw down crown

The screw down crown features a mechanism that can securely lock the crown when it is not being operated in order to prevent any operational errors and to improve its water resistant performance.

- It is necessary to unlock the screw down crown before operating it.
- Once you have finished operating the crown, make sure to relock it.

【To unlock the crown】

Turn the crown counterclockwise to unscrew it.
Now the crown can be operated.

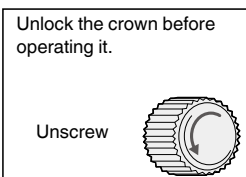

Crown locked

Crown unlocked

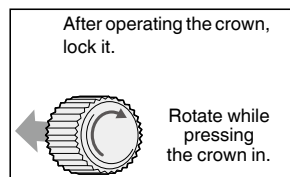
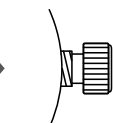

* When locking the crown, turn it slowly with care, ensuring that the screw is properly engaged. Be careful not to push it in forcefully, as doing so may damage the screw hole in the case.

How to use (how to wind the mainspring)

This watch is a self-winding watch equipped with a manual winding mechanism.

- When the watch is worn on the wrist, the motion of the wearer's arm winds the mainspring of the watch.
- When first using a stopped watch, it is recommended that you manually wind the mainspring by turning the crown.

● How to manually wind the mainspring by turning the crown

- 1** The crown is a screw down crown. Turn the crown counterclockwise to unlock the screw. (When the screw is completely unlocked, the crown is projected outward from its original position.)

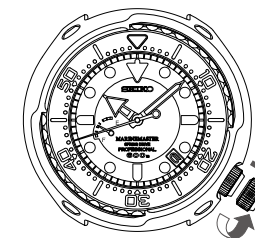

- 4** Gently turn the crown clockwise while pressing it, until it is screwed all the way in and locked.

* While screwing the crown in, the watch clicks as the mainspring is wound. This should not cause any concern since this is caused by movement of the mainspring.

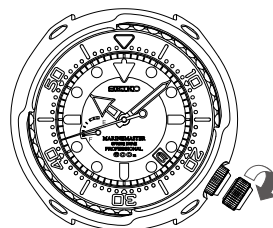
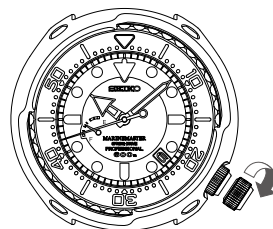
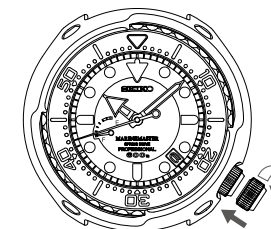

- 2** After unlocking the screw, slowly turn the crown clockwise to wind the main-spring. Take care not to press down the crown.

* As for manual winding, if you give the crown five full rotations, it provides the power to run the watch for approximately ten hours.

* If the crown is turned counterclockwise, the mainspring of the watch will not be wound.

- 3** Wind the mainspring until the power reserve indicator shows a full-wound state. Immediately, the seconds hand starts moving.

* To check the winding state of the mainspring, refer to "How to read the power reserve indicator" → (P. 26).

* There is no need to turn the crown further when the mainspring is fully wound. The crown can be turned without damaging the watch mechanism; it only winds the mainspring free.

How to set the time and date

The watch is provided with a date function and is so designed that the date changes once every 24 hours.

The date changes around 12 o'clock midnight. If AM/PM is not properly set, the date will change at 12 o'clock noon.

⚠ CAUTION

Do not set the date between 9:00 p.m. and 1:00 a.m.

Amending the date during this time period may cause problems such as the date failing to change the next day.

4 Pull out the crown to the second click and set the time.

Pull out the crown to the second click when the seconds hand is at the 12 o'clock position; the seconds hand stops on the spot.

Turn the crown to advance the hands until the date changes to the next. The time is now set for the A.M. period. Advance the hands to set the correct time. While doing so, set the minute hand about ten minutes behind the correct time, and then slowly advance it to the desired time.

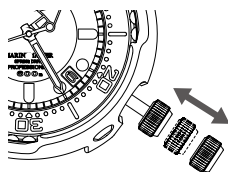

5 Push the crown back in to the normal position in accordance with a time signal.

The seconds hand immediately starts moving.

* The telephone time signal service is helpful for setting the seconds hand exactly.

6 Relock the crown.

* "Screw down crown" → P. 17

1 Unlock the crown.

* "Screw down crown" → P. 17

2 Pull out the crown to the first click.

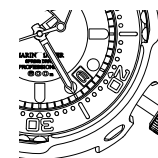

Pull out the crown to the first click

3 The date can be set by turning the crown counterclockwise.

Turn it until the previous day's date appears.

Ex.) To display the date as "6," then set this to "5." Turn the crown to the left (counterclockwise) to set the date.

Tips for more accurate time setting

Take notice of the following points in order to set the time more accurately.

Before setting the time, wind the mainspring until the power reserve indicator shows a full-wound state.

When using a watch after it has stopped, wait approximately 30 seconds after the seconds hand starts moving, and then pull the crown out to the second click.

Do not stop the seconds hand with the crown being at the second click position for thirty minutes or longer. If the time the crown has been at the second click position and the seconds hand has been stopped exceeds 30 minutes, push the crown back in to its original position, and let the seconds hand move for 30 seconds or longer, then restart the time setting.

■ Date adjustment at the end of the month

It is necessary to adjust the date at the end of February and 30-day months.

Ex.) To adjust the date in the A.M. period on the first day of a month following a 30-day month
The watch displays "31" instead of "1." Pull out the crown to the first click.
Turn the crown counterclockwise to set the date to "1" and then push the crown back in to the normal position.

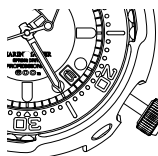

Pull out the crown to the first click

⚠ CAUTION

- Return the screw down crown fully to its original position.
- Avoid amending the date when the watch is displaying between 9 PM and 1 AM. Doing so may cause damage.

- * When the mainspring is fully wound, the crown can be turned further, or the mainspring may wind without damaging the mainspring itself. The mainspring of the watch employs a slipping attachment structure, a self-winding watch specific mechanism, to prevent the mainspring from over winding.
- * The orientation of "the power reserve indicator" may slightly vary depending on the model.

● Remarks on the self-winding mechanism of the mainspring

- The mainspring of the watch becomes fully wound when it is worn for twelve hours for three to five days.
- The winding state of the mainspring may vary depending on actual use conditions, such as the number of hours you wear the watch or the extent of your movement while wearing it. It is recommended that you observe the power reserve indicator to check the level of remaining power of your watch.
- * In a case where you wear the watch for a short period of time each day, observe the power reserve indicator to check the level of the remaining power. If necessary, manually wind the mainspring.

How to read the power reserve indicator

- The power reserve indicator lets you know the winding state of the mainspring.
- Before removing the watch from your wrist, observe the power reserve indicator to check if the watch has stored enough power to keep running until the next time you wear it. If necessary, wind the mainspring. (To prevent the watch from stopping, wind the mainspring to store the excess power that will allow the watch to run for extra time.)

The Power Reserve Indicator						
The winding state of the mainspring	Fully wound		Half wound		Unwound	
The number of hours the watch can run	Approximately 72 hours (3 days)		Approximately 36 hours (1 day and a half)		The watch either stops or is running down.	

How to use the rotating bezel

By setting the rotating bezel beforehand, the elapsed time since the start of an event can be measured.

- At the start of the event, for which you want to measure the elapsed time (for example, when you start diving), rotate the bezel so that the ▽ mark on the bezel is aligned with the minute hand.**

- * The rotating bezel is designed to rotate only counterclockwise.
Do not forcibly rotate it clockwise.
"[One-Way rotating bezel]" → P. 29

Example: When you start diving at 10:10 am.

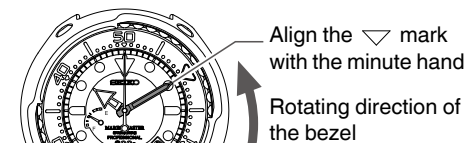

Align the ▽ mark with the minute hand
Rotating direction of the bezel

- Read the graduation on the rotating bezel to which the minute hand is pointing.**
The graduation on the rotating bezel to which the minute hand is pointing indicates the elapsed time.

Example: After 20 minutes has elapsed

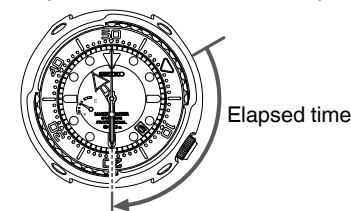

Elapsed time

- * The above illustration is provided as an example, therefore it may not be exactly the same as your watch.

[One-Way rotating bezel]

As the evaluation of the remaining air in your cylinder is based on the information of the elapsed time of the dive, the rotating bezel for a diver's watch is designed to rotate only counterclockwise, so that the watch is prevented from displaying the elapsed time shorter than it actually is.

CAUTION

Make sure that you check the correct remaining amount of air in your cylinder before diving. Use the display of the elapsed time by the rotating bezel only as a guide during diving.

Performance and type

The case back shows the caliber and performance of your watch

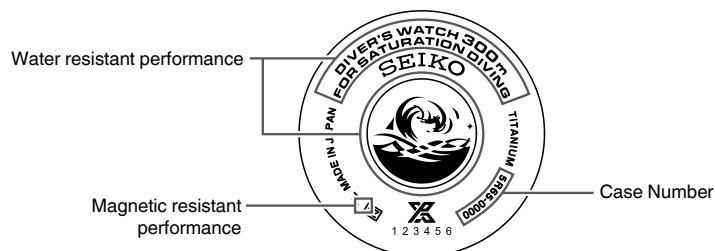

- **Water resistant performance**
- **Case Number**
The number to identify the type of your watch.
- **Magnetic resistant performance**
Refer to pages P. 33 and P. 34.

* The above illustration is provided as an example, therefore it may not be exactly the same as your watch.

Daily care

● **The watch requires good daily care**

- Do not wash the watch when its crown is in the extended position.
- Wipe away moisture, sweat or dirt with a soft cloth.
- After soaking the watch in seawater, be sure to wash the watch in clean pure water and wipe it dry carefully.
Do not pour running water directly from a faucet onto the watch. Put some water into a bowl first, and then soak the watch in the water to wash it.
* If your watch is rated as "Non-water resistant" or "water resistant for everyday life," do not wash the watch.
"Water resistant performance" → P. 14
"Performance and type" → P. 31

● **Turn the crown from time to time**

- In order to prevent corrosion of the crown, turn the crown from time to time.
- The same practice should be applied to a screw down crown.
"Screw down crown" → P. 17

Lumibrite

If your watch has Lumibrite

Lumibrite is a luminous paint that absorbs the light energy of sunlight and lighting apparatuses in a short time and stores it to emit light in the dark. For example, if exposed to a light of more than 500 lux for approximately 10 minutes, Lumibrite can emit light for 3 to 5 hours. Please note, however, that, as Lumibrite emits the light it stores, the luminance level of the light decreases gradually over time. The duration of the emitted light may also differ slightly depending on such factors as the brightness of the place where the watch is exposed to light and the distance from the light source to the watch.

* In general, when coming from a place that is bright to a place that is dark, it takes human eyes some time to adapt to the darkness making it difficult to see objects initially. (Dark adaptation)

* Lumibrite is luminous paint that stores and emits light, which is harmless to human beings and the environment, containing no toxic materials such as radioactive substances.

<Brightness levels>

Condition		Illumination
Sunlight	Fine weather	100,000 lux
	Cloudy weather	10,000 lux
Indoor (Window-side during daytime)	Fine weather	more than 3,000 lux
	Cloudy weather	1,000 to 3,000 lux
	Rainy weather	less than 1,000 lux
Lighting apparatus (40-watt daylight fluorescent light)	Distance to the watch: 1 m	1,000 lux
	Distance to the watch: 3 m	500 lux (average room luminance)
	Distance to the watch: 4 m	250 lux

Magnetic resistant performance

Affected by nearby magnetism,
a watch may temporarily gain or lose time or stop operating.

Diver's watches feature magnetic resistant performance which is equivalent to or above JIS Class 1.

⚠ DANGER	
Indication on the case back	Condition of use
No indication	Keep the watch more than 5 cm away from magnetic products. (JIS level-1 standard)
	Keep the watch more than 1 cm away from magnetic products. (JIS level-2 standard)

If the watch becomes magnetized and its accuracy deteriorates to an extent exceeding the specified rate under normal use, the watch needs to be demagnetized. In this case, you will be charged for demagnetization and accuracy readjustment even if it happens within the guarantee period.

The reason why a watch is affected by magnetism

The built-in regulating mechanism is provided with a magnet, which may be influenced by a strong external magnetic field.

Band

The band touches the skin directly and becomes dirty with sweat or dust. Therefore, lack of care may accelerate deterioration of the band or cause skin irritation or stain on the sleeve edge. The watch requires a lot of attention for long usage.

● Metallic band

- Moisture, sweat or soil will cause rust even on a stainless steel band if they are left for a long time.
- Lack of care may result in a rash or cause a yellowish or gold stain on the lower sleeve edge of shirts.
- Wipe off moisture, sweat or soil with a soft cloth as soon as possible.
- To clean the soil around the joint gaps of the band, wipe it out in water and then brush it off with a soft toothbrush.
(Protect the watch body from water splashes by wrapping it up in plastic wrap etc.)
Clean it off with a soft cloth.
- Because some titan bands use pins made of stainless steel, which has outstanding strength, rust may form in the stainless steel parts.
- If rust advances, pins may poke out or drop out, and the watch case may fall off the band, or the clasp may not open.
- If a pin is poking out, personal injury may result. In such a case, refrain from using the watch and request repair.

Examples of common magnetic products that may affect watches



Smartphone, cellular phone,
tablet terminal (speaker)

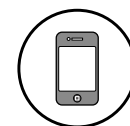

AC adapter



Bag
(with magnet
buckle)



AC-powered
shaver

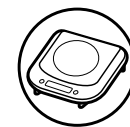

Magnetic cooking
device

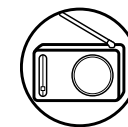

Portable radio
(speaker)

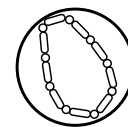

Magnetic
necklace

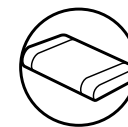

Magnetic health
pillow

● Polyurethane band

- A polyurethane band is susceptible to discoloration from light, and may be deteriorated by solvent or atmospheric humidity.
- Especially a translucent, white, or pale colored band easily adsorbs other colors, resulting in color smears or discoloration.
- Wash out dirt in water and clean it off with a dry cloth.
(Protect the watch body from water splashes by wrapping it up in plastic wrap etc.)
- When the band becomes less flexible, have the band replaced with a new one. If you continue to use the band as it is, the band may develop cracks or become brittle over time.

● Silicone band

- As for material characteristics, the band is easily dirtied, and may be stained and discolored. Wipe off dirt with a wet cloth or cleaning tissue.
- Unlike bands of other materials, cracks may result in the band being cut. Take care not to damage the band with an edged tool.

Notes on skin irritation and allergy	Skin irritation caused by a band may result from various factors such as allergy to metals or leathers, or skin reactions against friction on dust or the band itself.
Notes on the length of the band	Adjust the band to allow a little clearance with your wrist to ensure proper airflow. When wearing the watch, leave enough room to insert a finger between the band and your wrist.



How to use the diver adjuster

2

TO PRESERVE THE QUALITY OF YOUR WATCH

If your watch's metallic band has the Diver Adjuster function, the length of the band can be easily adjusted.

It is very useful when you wear the watch over a wet suit or winter clothing.

- 1 Lift up the flap approximately 90° until it stands upright, and then press the flap down further approximately 20° and lightly hold it.

- When doing so, take care not to push the flap forcibly. Although you may feel slight resistance, doing this requires only a light force.

- 2 Lightly pull the band on the 6 o'clock side of the watch along the curved line of the band to pull out the slider.

- Doing this requires only a light force. Take care not to pull the band forcibly.
- The slider can be pulled out approximately 30 mm. Take care not to pull it out more than this limit.

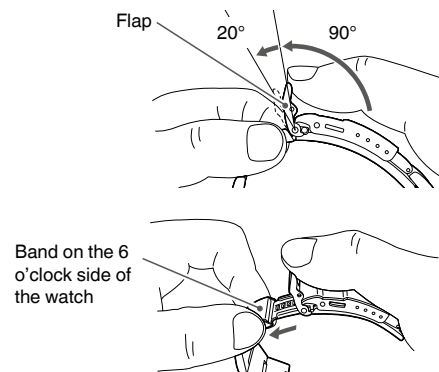

EN 37

How to use the diver extender

2

TO PRESERVE THE QUALITY OF YOUR WATCH

If your watch's metallic band has the Diver Extender function, the length of the band can be easily adjusted.

It is very useful when you wear the watch over a wet suit or winter clothing.

- 1 Lift up the flap.

- 2 While pressing the push button, open the clasp.

- After opening the clasp, push the flap back to the normal position for safety's sake.

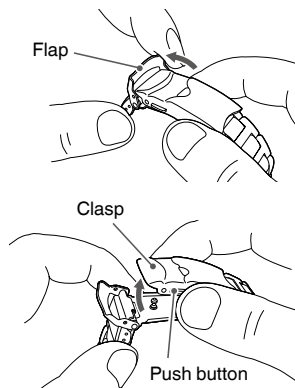

EN 39

- 3 While pressing the push button, lift up the clasp to release the buckle, and place the watch on your wrist.

- 4 Close the clasp (4-1) first and then, the flap (4-2).

- 5 Hold both sides of the band to adjust the length of the slider until it fits snugly around your wrist.

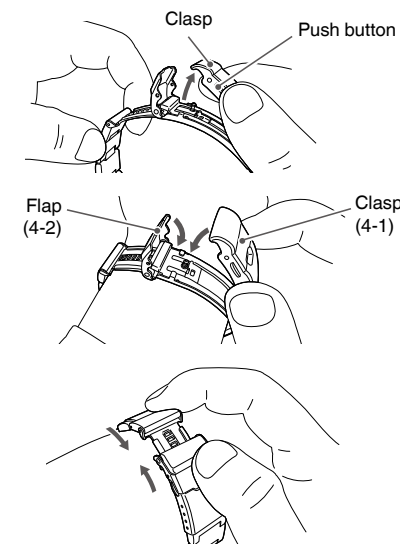

2

TO PRESERVE THE QUALITY OF YOUR WATCH

- 3 Open the two-piece foldover portion of the Diver Extender in the direction of the arrow.

- Some force is required to open the foldover portion, and it will click when it is opened.

- 4 Slide the upper cover of the Diver Extender in the direction of the arrow, and then, pull it up to extend the two-piece foldover portion to the full extent.

- 5 Place the watch on your wrist, and close the clasp (5-1) first and then, the flap (5-2).

- * To fold up the Diver Extender, reverse the procedure above. When the two-piece folder portion of the Diver Extender is folded up completely, it also clicks in the same manner as when it is opened.

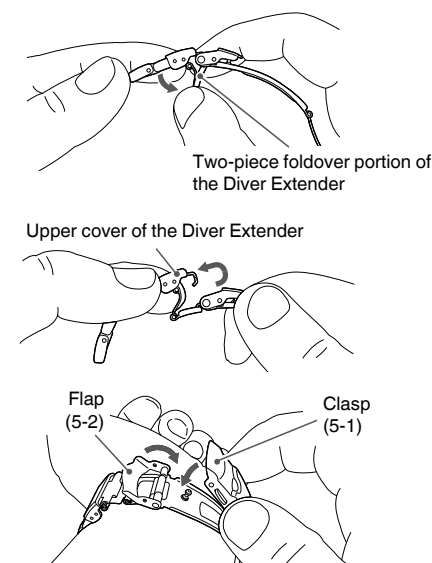

2

TO PRESERVE THE QUALITY OF YOUR WATCH

EN 40

After sales service

2

TO PRESERVE THE QUALITY OF YOUR WATCH

● Notes on guarantee and repair

- Contact the retailer from whom the watch was purchased or SEIKO CUSTOMER SERVICE CENTER for repair or overhaul.
- Within the guarantee period, present the certificate of guarantee to receive repair services.
- Guarantee coverage is provided in the certificate of guarantee.
Read carefully and retain it.
- For repair services after the guarantee period has expired, if the functions of the watch can be restored by repair work, we will undertake repair services upon request and payment.

● Replacement with functional parts

- Please keep in mind that if original parts are not available, they may be replaced with substitutes whose outward appearance may differ from the originals.

● Inspection and adjustment by disassembly and cleaning (overhaul)

- Periodic inspection and adjustment by disassembly and cleaning (overhaul) is recommended approximately once every 3 to 4 years in order to maintain optimal performance of the watch for a long time.
- The power transmission gear of the movement of this watch constantly receives force. To ensure that this mechanism works properly all the time, washing parts, changing oil, adjusting accuracy, checking functions and replacing consumable parts on a regular basis are important. The first overhaul after the purchase of your watch is particularly important for preserving long-time use of your watch. According to use conditions, the oil retaining condition of your watch mechanical parts may deteriorate, abrasion of the parts may occur due to contamination of oil, which may ultimately lead the watch itself to stop. As the parts such as gasket may deteriorate, water resistant performance may be impaired due to intrusion of perspiration and moisture.
Inspection and adjustment by disassembly and cleaning (overhaul) should be performed by the retailer from whom the watch was purchased, and who specifies "SEIKO GENUINE PARTS." At this time, also request replacement of the gasket and the spring bar.
- When your watch is inspected and adjusted by disassembly and cleaning (overhauled), the movement of your watch may be replaced.

⚠ CAUTION

Depending on the environment where a diver's watch is used, its inner parts or movement as well as its case or band may be affected. We recommend that you have your watch overhauled regularly once every 3 or 4 years.

EN 41

Troubleshooting

2

TO PRESERVE THE QUALITY OF YOUR WATCH

Troubles	Possible causes	Solutions
The watch stops operating.	The mainspring has not been wound.	Wind up the watch as per "How to use (how to wind the mainspring)" → (P. 18), and set the time. If the watch still does not operate, consult the retailer from whom the watch was purchased.
Even though you wear the watch every day, the power reserve indicator does not move up.	The watch is worn on your wrist only for a short period of time, or the amount of arm movement is small.	Wear the watch for an extended period of time, or when taking off the watch, turn the crown to wind the mainspring if the remaining power shown by the power reserve indicator is not sufficient for the next use.
The watch stops even though the power reserve indicator is not showing "0".	The watch has been left at a low temperature (below 0°C).	Turn the crown to wind the mainspring and reset the time. At a temperature below 0°C, the watch may stop if the power reserve indicator is showing less than one-sixth of the power reserve.

Troubles	Possible causes	Solutions
The watch temporarily gains/loses time.	The watch has been left in extremely high or low temperatures for a long time.	Return the watch to a normal temperature so that it works accurately as usual, and then reset the time. The watch has been adjusted so that it works accurately when it is worn on your wrist under a normal temperature range between 5°C and 35°C.
	The watch has been left close to an object with a strong magnetic field.	Correct this condition by moving and keeping the watch away from the magnetic source, and reset the time. If this action does not correct the condition, contact the retailer from whom the watch was purchased.
	You drop the watch, hit it against a hard surface, or wear it while playing active sports. The watch is exposed to strong vibrations.	If accuracy does not return after setting the time, consult the retailer from whom the watch was purchased.
Right after starting the watch, it seems that the seconds hand moves more quickly than usual when setting the time.	When the watch starts moving, it takes a little time before the speed-regulating unit starts operating. (This is not a malfunction.)	It takes several seconds before the speed-regulating unit starts operating. To set the time correctly, wait for approximately 30 seconds after the seconds hand starts to move, and set the time.
The date changes at 12 o'clock noon.	AM/PM is not properly set.	Advance the hands by 12 hours.
Blur in the display persists.	Small amount of water has got inside the watch due to deterioration of the gasket, etc.	Consult the retailer from whom the watch was purchased.

* For a solution to a problem other than listed above, contact the retailer from whom the watch was purchased.

EN 43

EN 42

2

TO PRESERVE THE QUALITY OF YOUR WATCH

EN 44

Specifications

Cal.	5R65
1.Features	3 hands (Hour, Minute and Seconds hands), hand, Date display, Power Reserve Indicator
2. Frequency of crystal oscillator	32,768 Hz
3. Loss/gain (daily rate)	±15 seconds (±1 second per day) (Only if worn on the wrist in a temperature range of 5°C to 35°C)
4. Operational temperature range	-10 °C to +60 °C Under a low-temperature condition (below 0 °C), always keep at least one-sixth of the watch power shown by the power reserve indicator.
5. Driving System	Automatic winding type with manual winding mechanism
6. Hand movement	Glide motion
7. Continuous operating times	Approx. 72 hours (Approx. 3 days) * When the power reserve indicator shows fully wound.
8. IC (Integrated Circuit)	Oscillator, frequency divider, and spring drive control circuit (C-MOS-IC): 1 piece
9. Jewels	30 jewels

* The specifications are subject to change without prior notice due to product improvements.